

1.2.3

PHYSIOL 1.2.3
Preloaded
injection system

1.2.3 PRELOADED INJECTION SYSTEM FOR 2.2 MM WOUND-ASSISTED MINI-INCISIONS

The Micro+ 1.2.3 lens is delivered preloaded in a mini-incision cartridge, which is simply clipped to the 1.2.3 single-use injector.

The 1.2.3 preloaded injection system requires no lens handling which ensures perfect control of asepsis and makes lens injection comfortable and reproducible.

INJECTION GUIDELINES

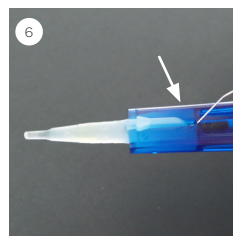
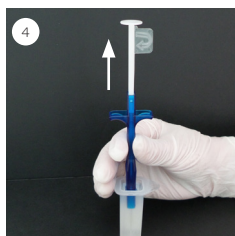
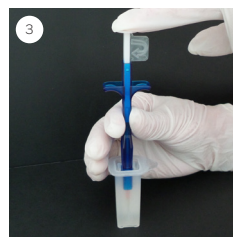
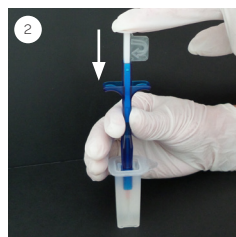

1. Connect the injector vertically onto the preloaded cartridge until you hear the "click".
2. Push the plunger completely down towards the safety catch and...
3. ...keep the plunger in this position for 3 seconds. This ensures the lens is securely loaded in the cartridge.
4. Gently release the plunger.
5. Remove the safety catch by a twist motion.
6. Rinse the IOL with BSS by introducing the canula of the syringe into the small hole on the body of the injector.

The assembling of the injector onto the cartridge must be performed right before implantation of the IOL.

PHYSIOL 1.2.3 IS AVAILABLE WITH:

