

MICRO+ MONOFOCAL OPTIC

1.2.3



MICRO+ 1.2.3 Preloaded hydrophilic IOLs

Technical specifications

Commercial name	Micro+ A 123	Micro+ AY 123	
Material	26% hydrophilic acrylic		
Overall diameter	10.75 mm		
Optic diameter	6.15 mm		
Optic	Biconvex aspheric aberration-correcting (-0.11 μ SA)		
Filtration	UV	UV & blue light	
Refractive index	1.46		
Abbe number	58		
Angulation	5°		
Injection system	PhysIOL 1.2.3		
Incision size	≥ 2.2 mm		
Spherical power	OD to 9D (1D steps) & 10D to 30D (0.5D steps)		
Square edge	360°		
Nominal manufacturer A constant	118.90		
Suggested A constant*		Interferometry	Ultrasound
	Hoffer Q: pACD	5.52	5.26
	Holladay 1: Sf	1.74	1.48
	SRK II: A	119.30	118.89
	SRK/T: A	118.90	118.59
	Haigis**: a0; a1; a2	1.36; 0.4; 0.1	1.04; 0.4; 0.1

Extreme diopters available non-preloaded with Medice Accuject 1.8 / 2.0 / 2.1 / 2.2 injection systems

Commercial name	Micro+ A	Micro+ AY
Spherical power	-10D to -1D and 31D to 35D (1D steps)	31D to 35D (1D steps)

* Estimates only; surgeons are recommended to use their own values based upon their personal experience. Refer to our website for updates.
 ** Not optimized.

1.2.3

1.2.3 PRELOADED INJECTION SYSTEM FOR 2.2 MM WOUND-ASSISTED MINI-INCISIONS

The Micro+ 1.2.3 lenses are delivered preloaded in a mini-incision cartridge, which is simply clipped to the 1.2.3 single-use injector. The 1.2.3 preloaded injection system requires no lens handling which ensures perfect control of asepsis and makes lens injection comfortable and reproducible.

INJECTION GUIDELINES

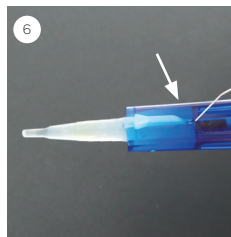
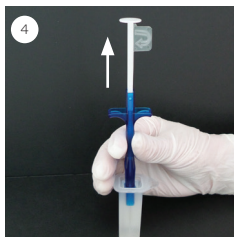
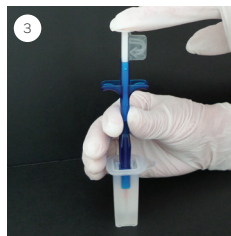
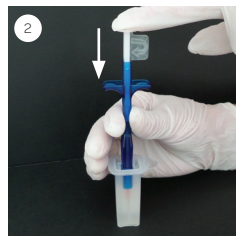
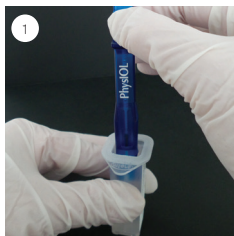

1. Connect the injector vertically onto the preloaded cartridge until you hear the "clip".
2. Push the plunger completely down towards the safety catch and...
3. ...keep the plunger in this position for 3 seconds. This ensures the lens is securely loaded in the cartridge.
4. Gently release the plunger.
5. Remove the safety catch by a twist motion.
6. Rinse the IOL with BSS by introducing the canula of the syringe into the small hole on the body of the injector.

The assembling of the injector onto the cartridge must be performed right before implantation of the IOL.

Distributed by



PhysIOL sa/nv - Liège Science Park - Allée des Noisetiers 4 - 4031 Liège - Belgium
t. +32 (0)4 361 05 49 - f. +32 (0)4 361 05 30 - info@physiol.be - www.physiol.eu